

PLAN SHOWING THE PROPOSED CONSTRUCTION OF A DWELLING HOUSE AT PRE-N^o: 37 NADUKUPPAM 3RD STREET, R.S.N^o: 973/56, DIVISION. N^o: 98, MADRAS.

SCALE 1" = 6'0" (1:72)

KEY PLAN (NOT TO SCALE)

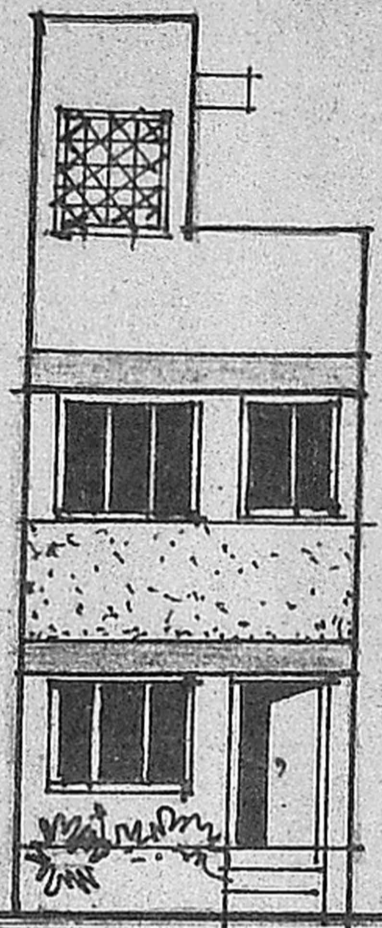
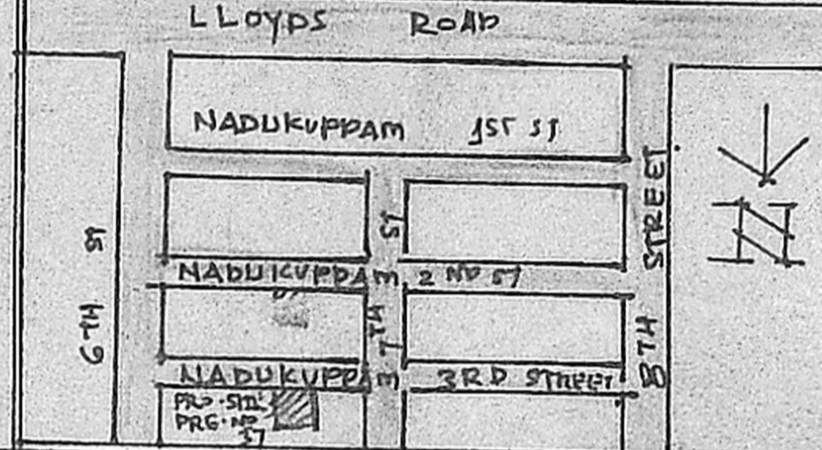

ELEVATION

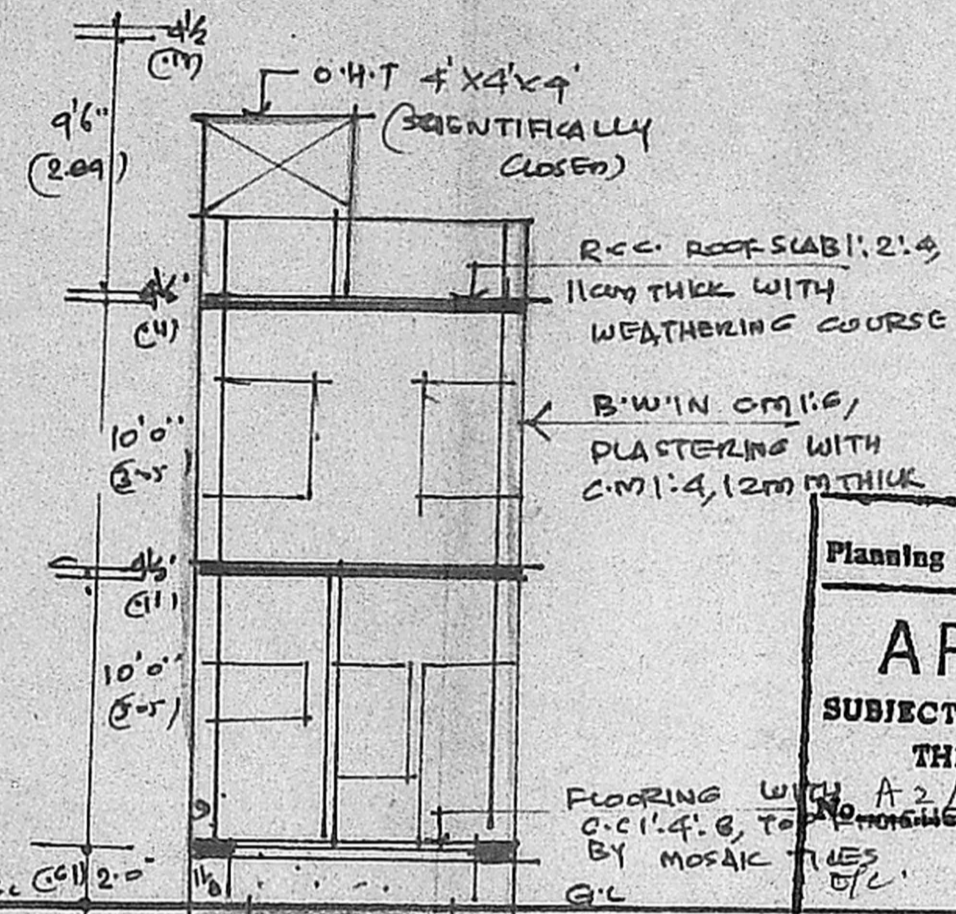

SECTION ON 'DD'

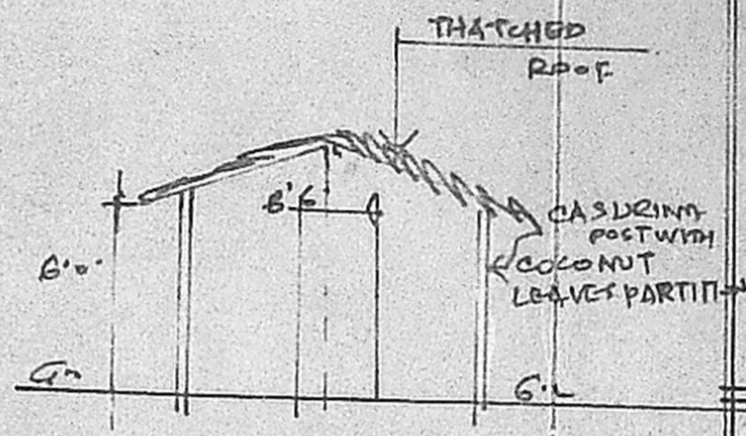

Planning Permit No. A/1515/90
APPROVED
 SUBJECT TO THE CONDITIONS IN THIS OFFICE LETTER.
 No. A2/20192/90 Date 16-11-90
 FOR MEMBER SECRETARY
 MADRAS METROPOLITAN DEVELOPMENT AUTHORITY
 MADRAS - 600 008.

SECTION ON 'BB'

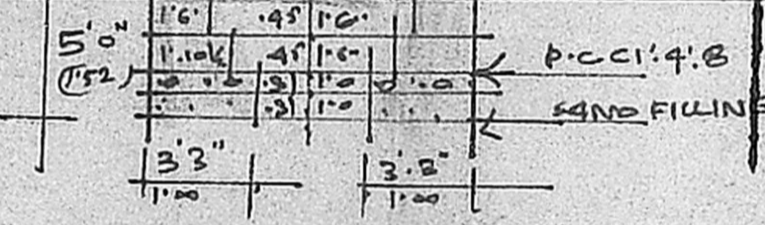

ELEVATION

AREA	90 FT	50-101
PLOT AREA	420-00	39-00
G. FLOOR AREA	270-00	25-00
F. FLOOR AREA	270-00	25-00
HEAD ROOM AREA	59-00	5-00
TOTAL AREA	599-00	55-00
PLOT COVERAGE	64%	-
FLOOR AREA RATIO	1.43	-

JOINERY	FT	MT.
D. DOOR	3'2" X 7'6"	1.00 X 2.13
D1 DOOR	3'0" X 7'6"	0.91 X 2.13
D2 DOOR	2'6" X 7'6"	0.76 X 2.13
W. WINDOW	3'0" X 4'6"	0.91 X 1.37
W1 WINDOW	5'0" X 4'6"	1.52 X 1.37
V. VENTILATOR	3'0" X 2'0"	0.91 X 0.61

NOTE	
ROADS	---
PROPOSAL	---
DEMOLITION	---
BOUNDARY	---

OWNER: A. Arun Kumar

LICENSED SURVEYOR: V. SRINIVASALU, L.C.E.
 Asst. Executive Engineer (Retd)
 Consulting Civil Engineer,
 REGD. No. 270,
 CLASS I LICENSED SURVEYOR CORPORATION OF MADRAS
 No. 60, Valluvar Road,
 ARUMHAKKAM MADRAS-10

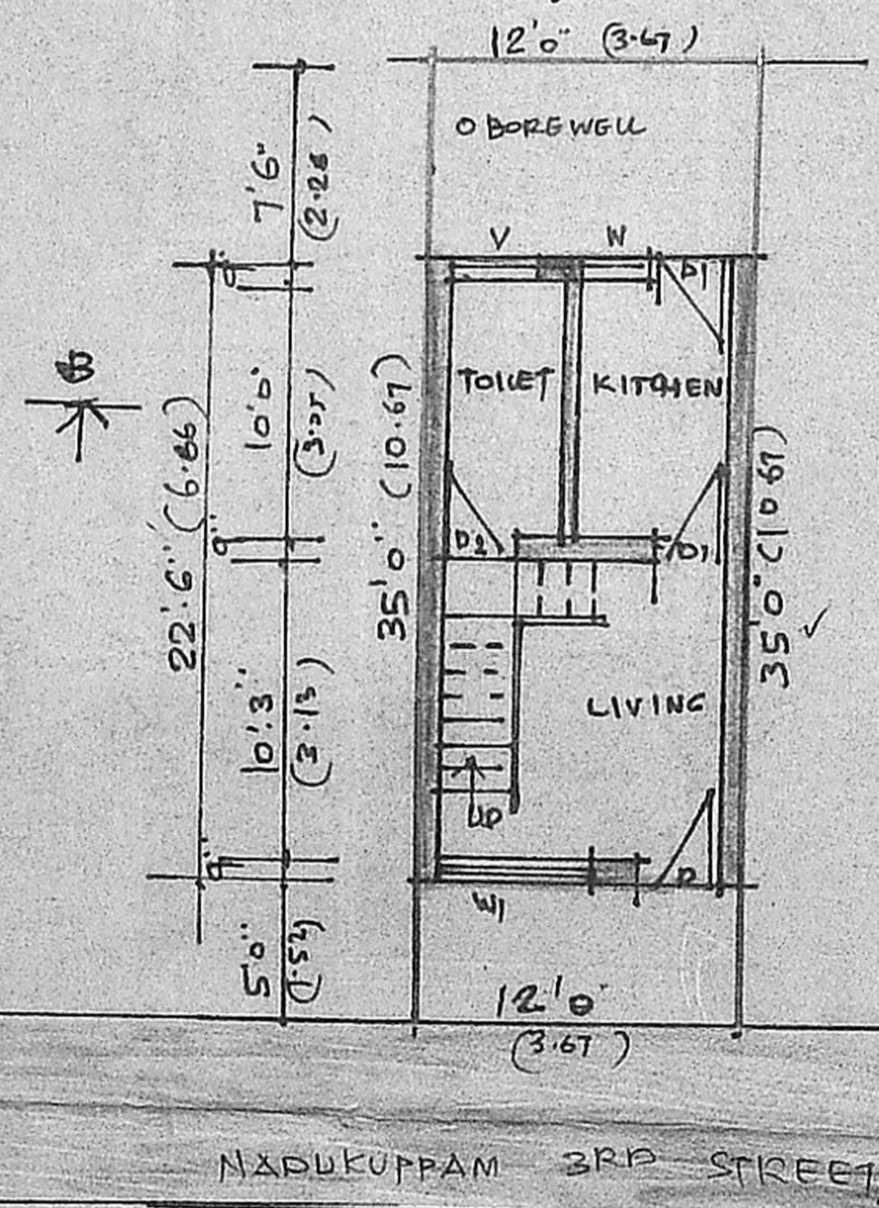

SITE PLAN CUM GROUND FLOOR PLAN

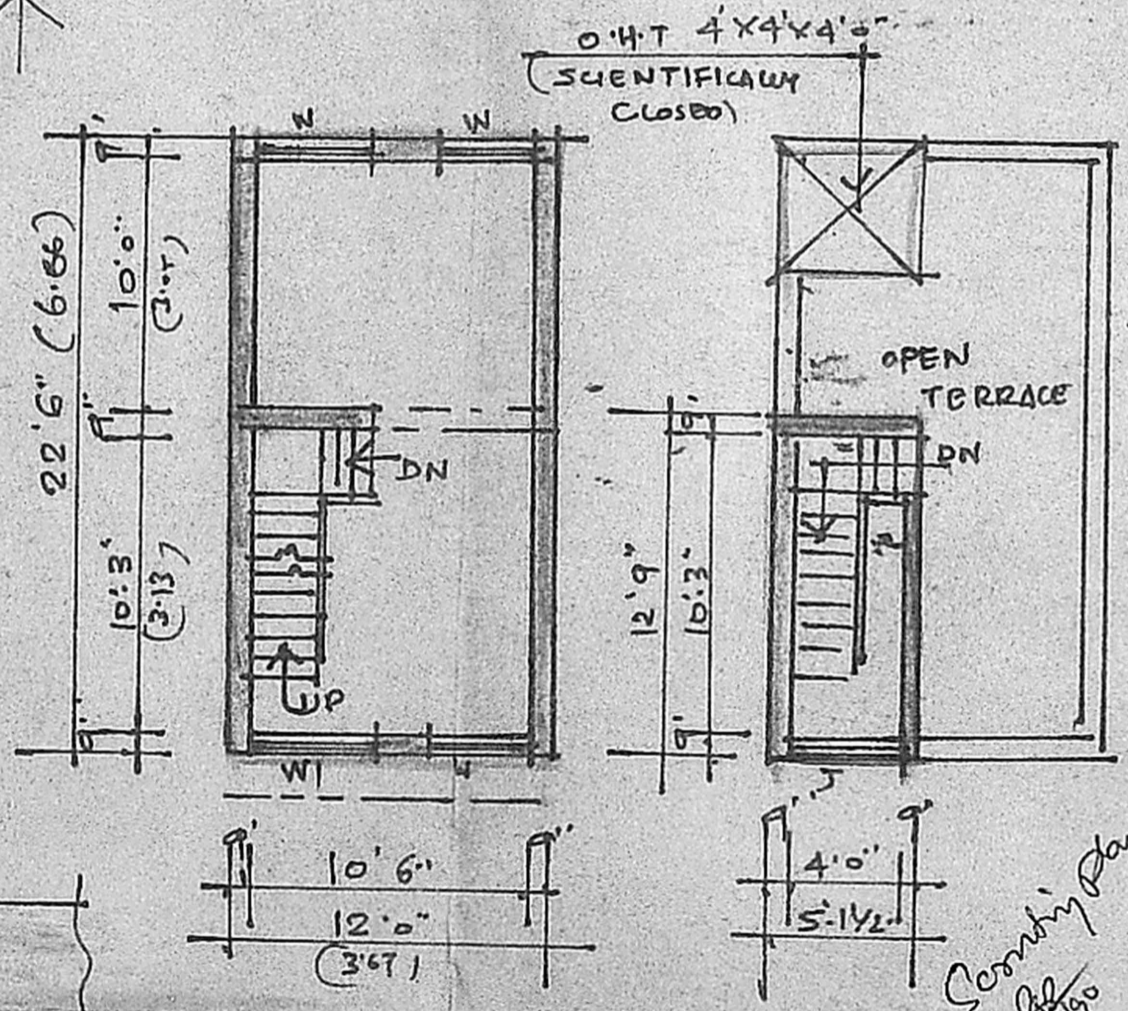

PLAN OF FIRST FLOOR

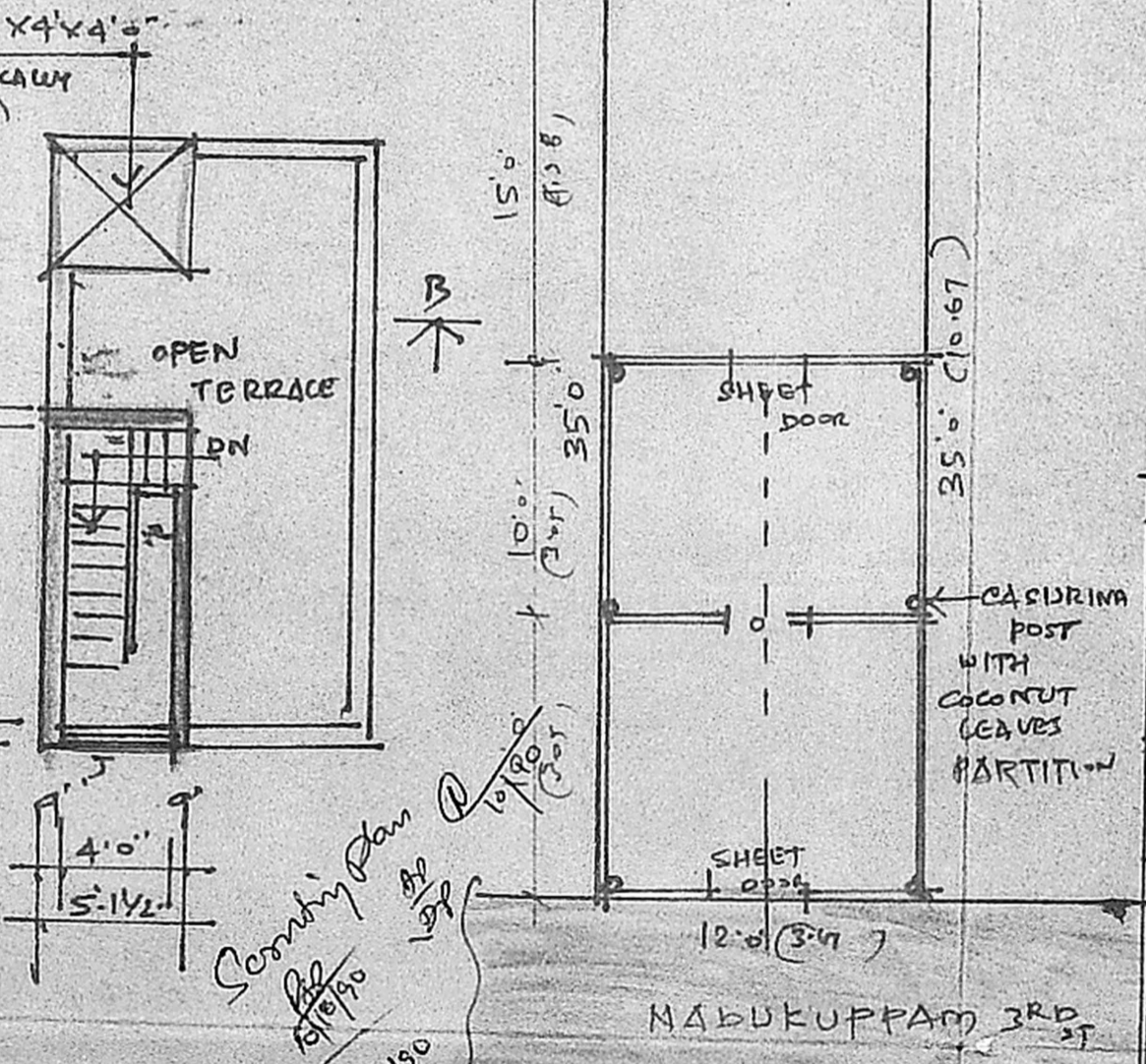

PLAN OF TERRACE FLOOR

Survey Plan No. A2/20192/90
 Date 16/11/90